



**TRU-TURF**

## SR72 SPORTS TURF ROLLER MANUAL



# Contents

Revised 17/11/2012

<b>MACHINE INFORMATION RECORD .....</b>	<b>1</b>
<b>SAFETY INFORMATION .....</b>	<b>2</b>
<b>WARRANTY .....</b>	<b>3</b>
<b>ASSEMBLY .....</b>	<b>5</b>
List of components .....	5
Assembly procedure.....	5
Attaching a tractor .....	5
<b>OPERATION .....</b>	<b>6</b>
Rolling only .....	6
To spike the field surface.....	6
To engage the rolling position.....	6
<b>GENERAL ASSEMBLY, LINKAGE &amp; MAIN PARTS .....</b>	<b>7</b>
<b>UPPER ASSEMBLY PARTS .....</b>	<b>8</b>
<b>LOWER ASSEMBLY PARTS .....</b>	<b>9</b>
<b>SPIKER GENERAL ASSEMBLY .....</b>	<b>10</b>
<b>SPIKER PARTS .....</b>	<b>11</b>



# Machine Information Record

Congratulations on your investment in the SR72 Sports Turf Roller and your move to smoother, faster, more consistent sports fields reducing the possibilities of injury. The following operation and maintenance manual has been prepared for use with the Tru-Turf Equipment SR72 Sports Roller. It is intended as a guide and supplemental updates to the manual may take place at a future date, without prior notice.

This roller is engineered to be simple to operate and easy to maintain. (If you have any questions or concerns that this manual does not address, please feel free to contact your distributor.)

This light weight roller is designed to be used on a regular basis to iron out ground imperfections. The offset rollers in this machine are unevenly spaced to ensure when the roller is used regularly that it will only continue to true and smooth the surface without compacting the ground. Single style rollers will exasebate a problem where Tru-Turf SR72 does not.

## Distributor Information

Name: \_\_\_\_\_

Address: \_\_\_\_\_  
\_\_\_\_\_

Telephone: \_\_\_\_\_

Fax: \_\_\_\_\_

Email: \_\_\_\_\_

## Machine Information

Model. **SR72 Sports Turf Roller**

Serial No. \_\_\_\_\_

Purchase Date No. \_\_\_\_\_

# Safety Information

## Safety Information

**Safety is of the utmost importance when operating this equipment.**

**To ensure safe operation of the SR72 Sports Turf Roller, please follow the following safety guidelines.**

- Always make a pre-operation inspection. If this procedure is not carried out damage to property or personnel may occur.
- Keep children, pets and inexperienced personnel away from the machine. This machine should only be operated by trained and skilled personnel - check with your supervisor if you are unsure.
- Never permit inexperienced operators to use the machine. This machine requires certain knowledge and expertise to operate it; you must be a trained person to use this machine. Unskilled persons can harm themselves and others if they operate this machine.
- When operating, always keep hands and loose clothing away from rollers and blade area. If hair, clothing or loose objects become entangled on a rotating shaft serious bodily injury could occur.

**Operator, remember it is your responsibility to be aware of your surroundings. To avoid accidents, think safe and operate safe.**

# Warranty

## Universal Conditions

Tru-Turf Pty. Ltd. (Tru-Turf) will repair or replace any item or part of a Tru-Turf Golf Greens Roller that is defective in workmanship or material for a period of twenty four (24) months or unless otherwise stated, from the date of delivery of the new product to the original end user. Items identified as warrantable will be repaired or replaced by an approved Tru-Turf Dealer.

## Products Protected By This Warranty

This Warranty relates to the following products

manufactured by Tru-Turf, listed by model series;

- a). GR7000, GR11000, RB48, RS48, R52 & SC48 series golf greens rollers.
- b). TR66 triplex smoothing heads and triplex mower attachment hardware.
- c). SR72 Sports Turf Roller.
- d). MT5000 Series Totes are covered for a period of twelve (12) months.

Ensure that your dealer has completed and submitted the Online Warranty Registration and Inspection Report Form applicable to your unit. This will ensure that it has been sent directly to Tru-Turf for registration.

## Parts Warranted by OEM Suppliers to Tru-Turf

Specific component parts supplied to Tru-Turf Pty. Ltd. by OEM suppliers are covered by that supplier's Warranty. These parts and components include Eaton Transmissions, Honda Engines, Sevcon & Curtis Controllers & Foot Pedals, Falk Gearboxes & Electric Motors. Only Tru-Turf manufactured parts qualify for the twenty four (24) month warranty.

## Normal Wear and Tear

Tru-Turf will not repair or replace parts that are subject to normal wear and tear and or that are subject to regular maintenance intervals as specified in the product Operator's Manual. These parts include, but are not limited to, oils, filters, tyres, shafts, bearings, blades, spikers, slicers, brakes, belts, hoses, spark plugs, drive chains, sprockets, drive rollers & smoothing rollers.

## Other Items Not Covered By This Warranty

Tru-Turf will not repair or replace any item that has been damaged by accident, lack of reasonable care and protection or lack of suitable storage. Tru-Turf will not warrant parts that have been altered or modified, nor aftermarket parts fitted without written Tru-Turf approval. Tru-Turf will not warrant used parts that are installed in place of failed parts.

Tru-Turf will not warrant parts that have not been installed by an approved Tru-Turf dealer, nor will Tru-Turf warrant parts that have not been maintained per the Operator's Manual.

The product is to be made available for Warranty repairs at the approved Tru-Turf dealer's premises or by arrangement with the approved dealer.

Service calls, overtime-labour rates and freight costs related to the return of the faulty product to Tru-Turf or its agents are not included.

Tru-Turf shall not be liable for any consequential loss, damage or costs incurred by or incidental to the failure of any new part supplied with the original purchase or any new part supplied as a replacement for any failed part.

Ensure that you the owner or the Dealer has lodged the completed Warranty Registration and Inspection Report Form, On-line, applicable to your unit and that it has been returned to Tru-Turf for registration. This record must be referred to along with the reasons why the purchaser believes that the product or a part is defective in the categories of faulty material or workmanship.

Acceptance or rejection of the Warranty Claim is entirely at the discretion of Tru-Turf or their OEM Suppliers who warrant their own part/s.

The Warranty Registration and Inspection Report Form along with the TRU-TURF Pty. Ltd. Warranty Terms & Conditions statement are available for viewing, download or printing as a ready reference by simply clicking the link provided on our website.

The Warranty Registration and Inspection Report Form must be signed by both the Dealer Rep and the Customer and returned or any warranty claim/s will be denied.

*No person or organisation has the authority to modify the terms or conditions or limitations of this Warranty without the written consent of Tru-Turf.*

# Assembly

## Initial Assembly

When you receive the crate, the machine will be broken down into components ready for assembly. If you run into any problems during assembly, please feel free to call your local distributor or agent.

## List Of Components

QTY	Description
1	Operation, Maintenance and Parts Manual
1	Machine Body
2	Weight Bracket Plates
1	Chain Pivot Bracket
2	Weight Brackets
7	Link Pins ( $\frac{7}{8}$ " )
4	Washers ( $\frac{1}{2}$ " )
1	Chain
1	3 Point Linkage Top Bracket
7	Locking Pins
2	Bolts ( $\frac{3}{8}$ x 1" UNF and Nuts)
4	Bolts ( $\frac{3}{4}$ " x 2" UNC)
4	Washers ( $\frac{1}{2}$ " Spring)
4	Bolts ( $\frac{1}{2}$ " x $1\frac{3}{4}$ " UNF)

# Assembly

## Assembly Procedure

### Step 1.

Remove components from crate.

### Step 2.

Bolt the three point linkage top bracket onto the body using  $\frac{3}{4}$ " x 2" bolts and  $\frac{3}{4}$ " spring washers. (Note this bracket will only fit one way).

### Step 3.

Using 2 by  $\frac{7}{8}$ " link pins and 2 by  $\frac{7}{16}$ " locking pins attach chain to chain pivot bracket as per diagram on page 7.

## If Required

### Step 4.

Bolt the two weight carrying brackets on the top of the roller on the outer ends, ensure they are facing the correct way.

### Step 5.

First slide the weight bars into the outer brackets, then slide the other end into the slot on the 3 point linkage. Ensure the locking slot drops down and into place correctly. Put the  $\frac{3}{8}$ " x 1" UNF bolts and nuts in the weight bars at the 3 point linkage end, screw the nut on firmly to stop it vibrating off. This prevents the weight bar sliding out of position.

### Step 6.

As a option tractor outfront weights can be mounted on these weight bars to increase roller weight if required. It is advisable to place the weights equally on either side.

### Step 7.

Remember increasing the roller weight also means that a larger tractor is required to lift and carry the roller or add additional wheel weights to the tractor to avoid the possibility of the tractor raring or tipping over causing a accident and possible injury to personel.

## Attaching A Tractor

**Important: Tractor must have a minimum of 40 horse power towing capacity. (Additional roller weights means the use of a larger tractor).**

### Step 1.

Using 2 by  $\frac{7}{8}$ " link pins and 2 by  $\frac{7}{16}$ " locking pins attach the three point linkage arms to the bottom bracket holes on the body of the roller.

### Step 2.

Attach chain pivot bracket to the top bracket, keep the bracket close to vertical.

### Step 3.

Attach one end of chain to the chain pivot bracket using  $\frac{7}{8}$ " link pins, fasten with locking pin.

### Step 4.

Attach the other end of chain to the three point linkage, use the top bracket hole leave enough slack so that when the roller is raised the front roller is approximately 5" off the ground before the rear roller leaves the ground. This will ensure the roller follows the ground contours at all times.

# Operation

## **Rolling Only**

Rolling can be done at speeds of up to 12mph (19kph).  
Best results are achieved when there is a moisture content in the ground.

## **To Spike The Field Surface**

With the roller in the raised position, engage the spiker blades by using the black handle across the rear of body. Remove locking pins and push handle away from you. Select the 1" (2.5cm), 1½" (3.8cm) or 2"(5cm) depth setting as required. Pull towards yourself and replace locking pins. These pins prevent the black handle from disengaging when reversing only.

## **To Engage The Rolling Position**

With tractor moving forward slowly lower roller to ground, then accelerate to the desired rolling speed.

**Important: Do not turn sharp whilst spiking the fields or tearing of the grass may occur.**

# Roller Components

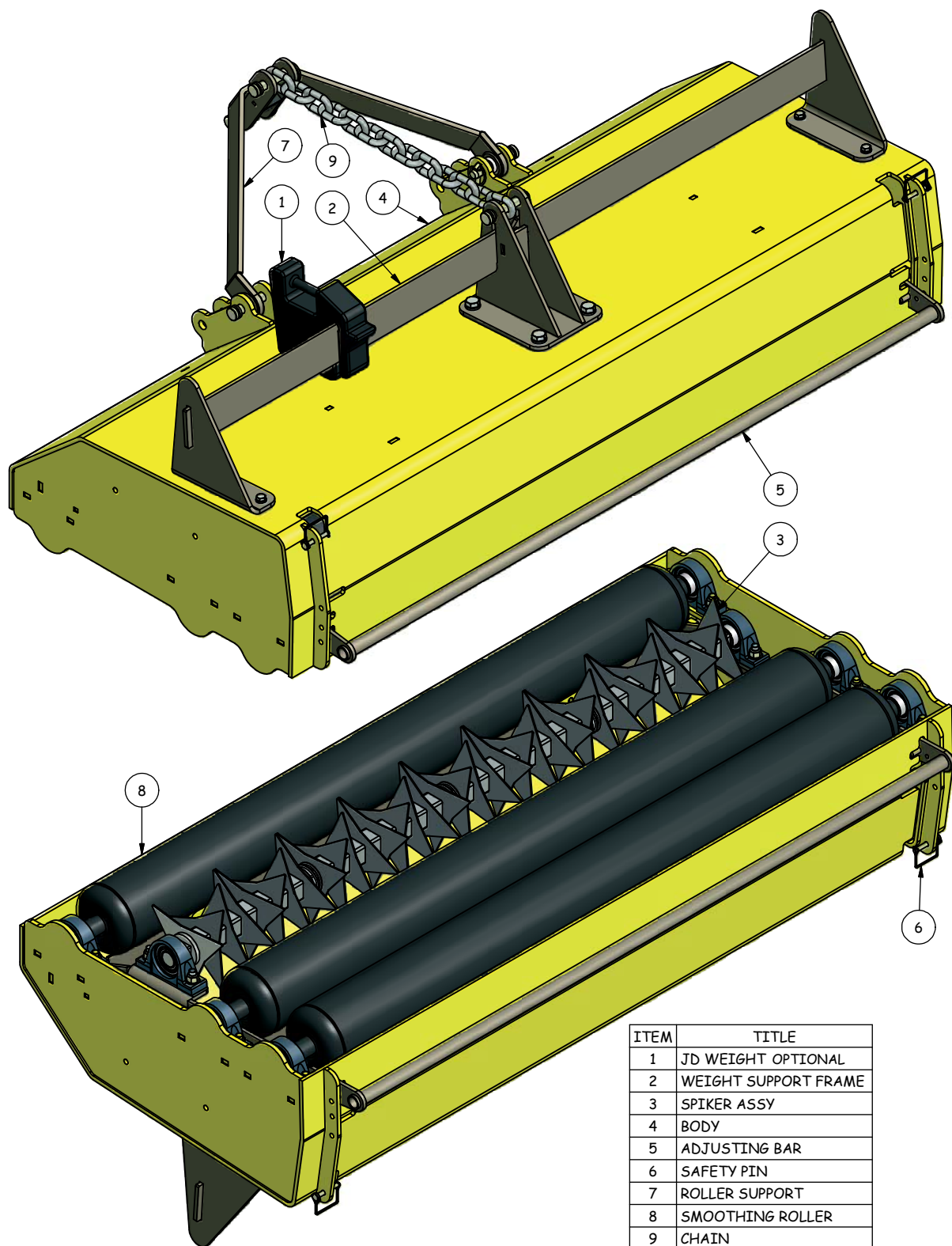

# Roller Components

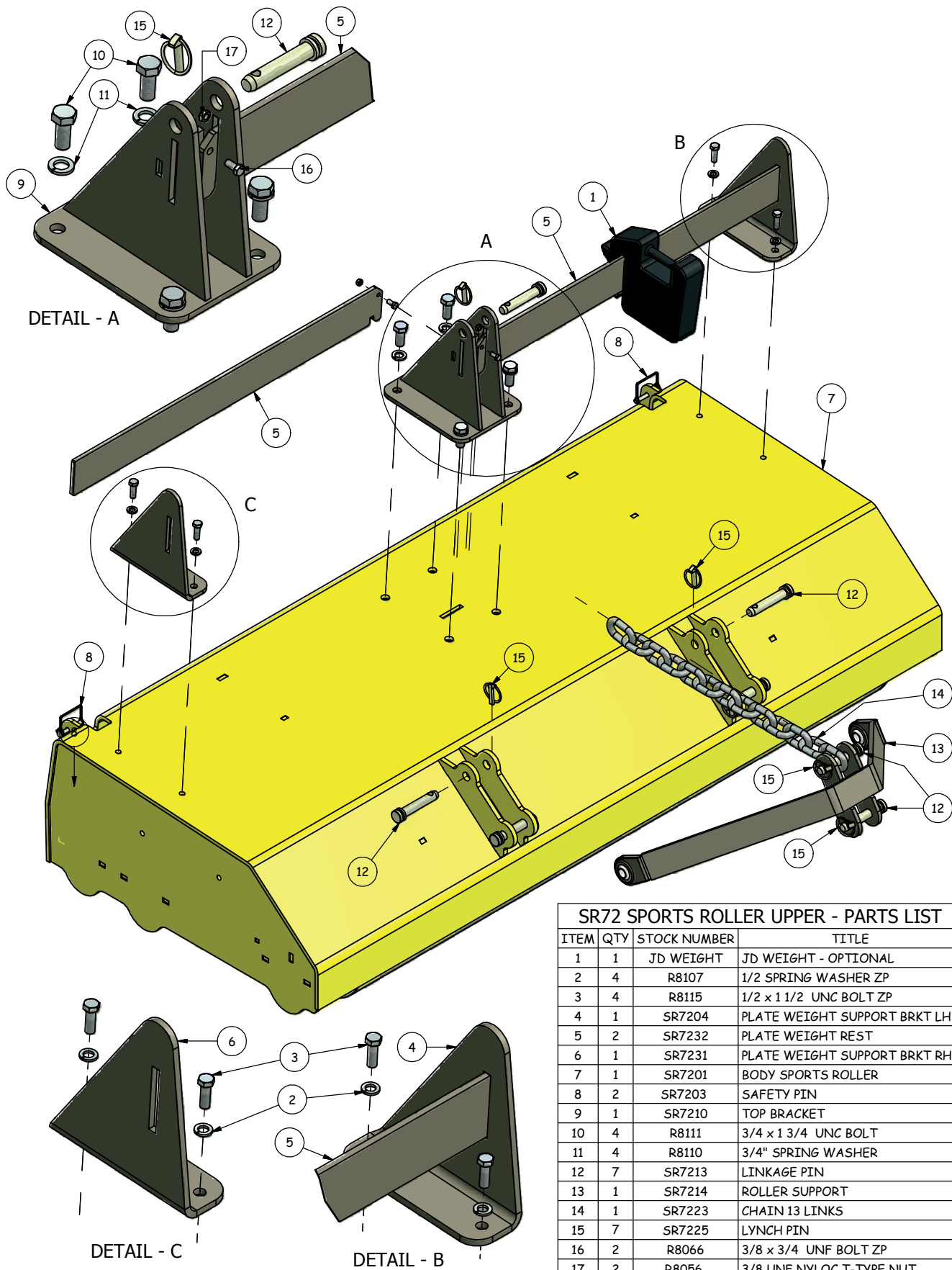

SR72 SPORTS ROLLER UPPER - PARTS LIST			
ITEM	QTY	STOCK NUMBER	TITLE
1	1	JD WEIGHT	JD WEIGHT - OPTIONAL
2	4	R8107	1/2 SPRING WASHER ZP
3	4	R8115	1/2 x 1 1/2 UNC BOLT ZP
4	1	SR7204	PLATE WEIGHT SUPPORT BRKT LH
5	2	SR7232	PLATE WEIGHT REST
6	1	SR7231	PLATE WEIGHT SUPPORT BRKT RH
7	1	SR7201	BODY SPORTS ROLLER
8	2	SR7203	SAFETY PIN
9	1	SR7210	TOP BRACKET
10	4	R8111	3/4 x 1 3/4 UNC BOLT
11	4	R8110	3/4" SPRING WASHER
12	7	SR7213	LINKAGE PIN
13	1	SR7214	ROLLER SUPPORT
14	1	SR7223	CHAIN 13 LINKS
15	7	SR7225	LYNCH PIN
16	2	R8066	3/8 x 3/4 UNF BOLT ZP
17	2	R8056	3/8 UNF NYLOC T-TYPE NUT

# Roller Components

SR72 SPORTS ROLLER LOWER - PARTS LIST

ITEM	QTY	STOCK NUMBER	TITLE
1	2	R8105	1 x 2 3/4 UNC BOLT ZP
2	6	R8060	1/2" UNC NYLOC NUT ZP
3	6	R8107	1/2 SPRING WASHER ZP
4	12	R8112	5/8 x 1.1/4 WASHER ZP
5	12	R8113	5/8 UNC NYLOC
6	6	R8167	M12 x 24x1.6 WASHER
7	3	SR034	ANGLE IRON SCRAPER
8	1	SR7201	BODY SPORTS ROLLER
9	1	SR7202	ADJUSTING BAR
10	2	SR7203	SAFETY PIN
11	4	SR7208	1" FLATWASHER ZP
12	3	SR7215	SMOOTHING ROLLER
13	6	SR7216	HOUSING BEARING UNIT P208K
14	12	R8079	5/16 x 5/16 GRUB SCREW BLK
15	6	SR7217	BEARING UC208

**NOTE:**

**SPIKER ASSEMBLY & 2 SMOOTHING ROLLERS NOT SHOWN IN THIS VIEW TO PROVIDE A CLEAR VIEW OF THE SCRAPER ANGLES & THE SPIKER ENGAGING ARM.**

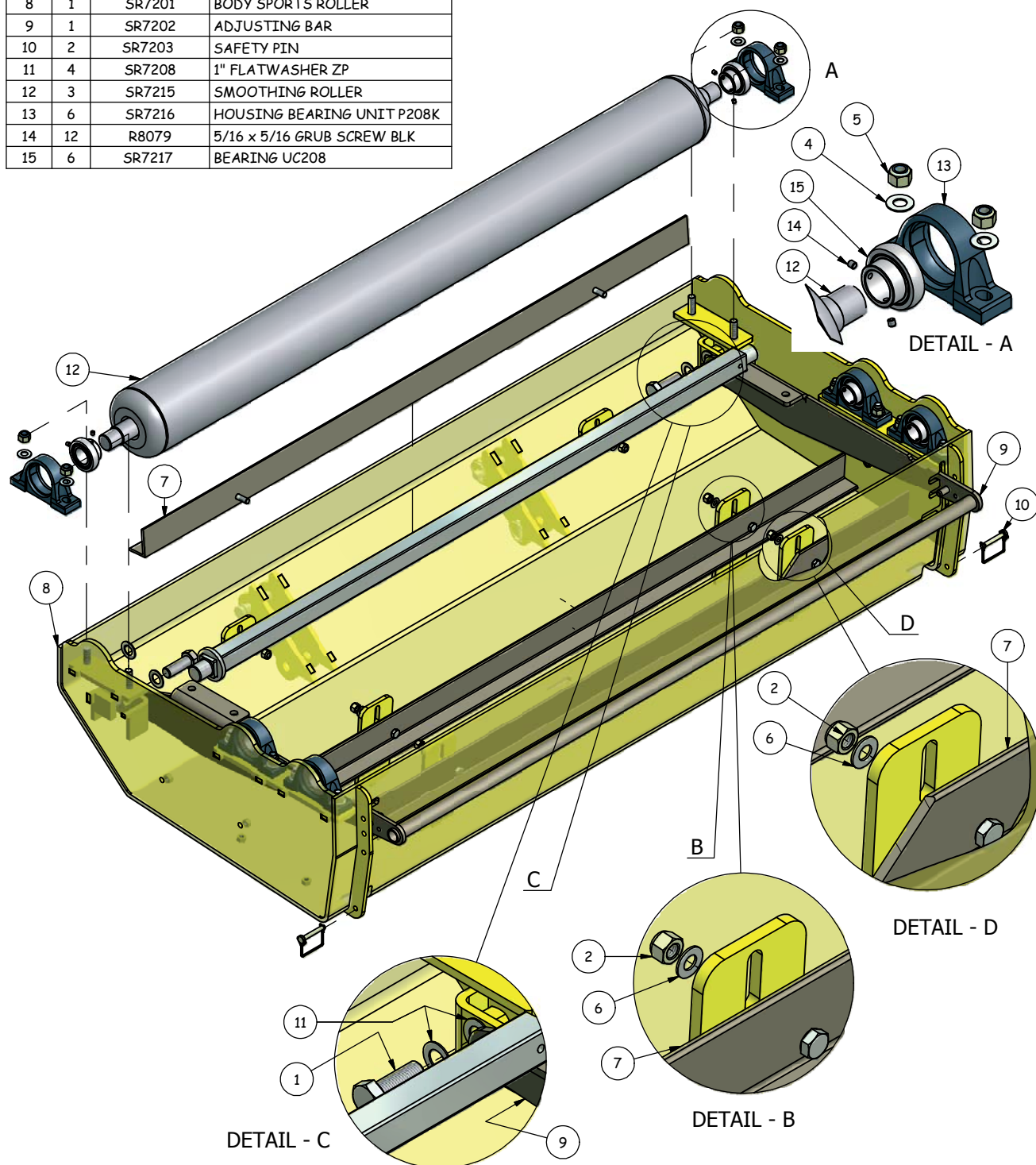

# Roller Components

**NOTE: 2 SMOOTHING ROLLERS NOT SHOWN IN THIS VIEW TO PROVIDE A CLEAR VIEW OF THE SCRAPER ANGLES & SPIKER ENGAGING ARM RELATED ITEMS.**

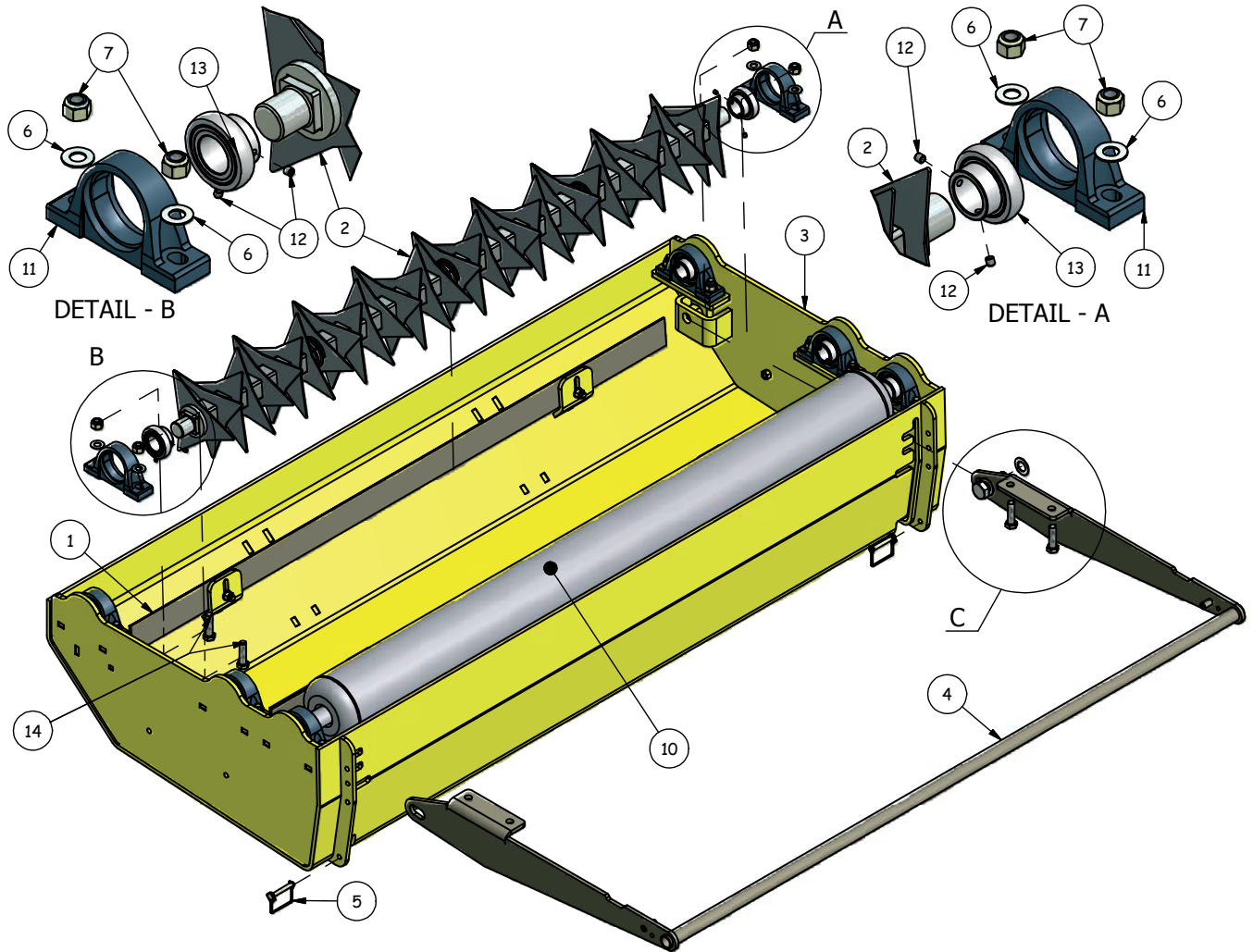

**SR72 SPORTS ROLLER LOWER SPIKER ASSY - PARTS LIST**

ITEM	QTY	STOCK NUMBER	TITLE
1	3	SR034	ANGLE IRON SCRAPER
2	1	SR108	SPIKER ASSY
3	1	SR7201	BODY SPORTS ROLLER
4	1	SR7202	ADJUSTING BAR
5	2	SR7203	SAFETY PIN
6	4	R8112	5/8 x 1.1/4 WASHER ZP
7	4	R8113	5/8 UNC NYLOC
8	2	R8105	1 x 2 3/4 UNC BOLT ZP
9	4	SR7208	1" FLATWASHER ZP
10	3	SR7215	SMOOTHING ROLLER
11	2	SR7216	HOUSING BEARING UNIT P208K
12	4	R8079	5/16 x 5/16 GRUB SCREW BLK
13	2	SR7217	BEARING UC208
14	4	R8114	5/8 x 2-1/4 UNC BOLT ZP

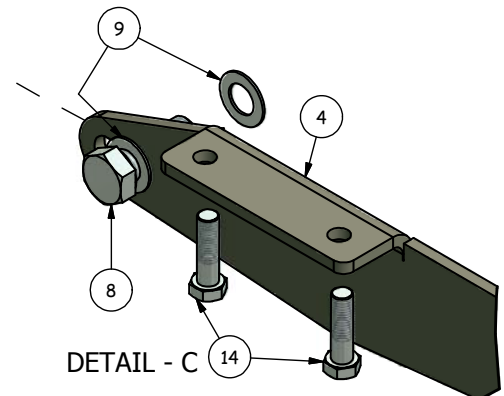

# Roller Components

